

SUPERFICIES PLANTA SOTANO

SUP.CONST.-	2.120.26 m ²
SUP.UTIL.-	1.791.23 m ²

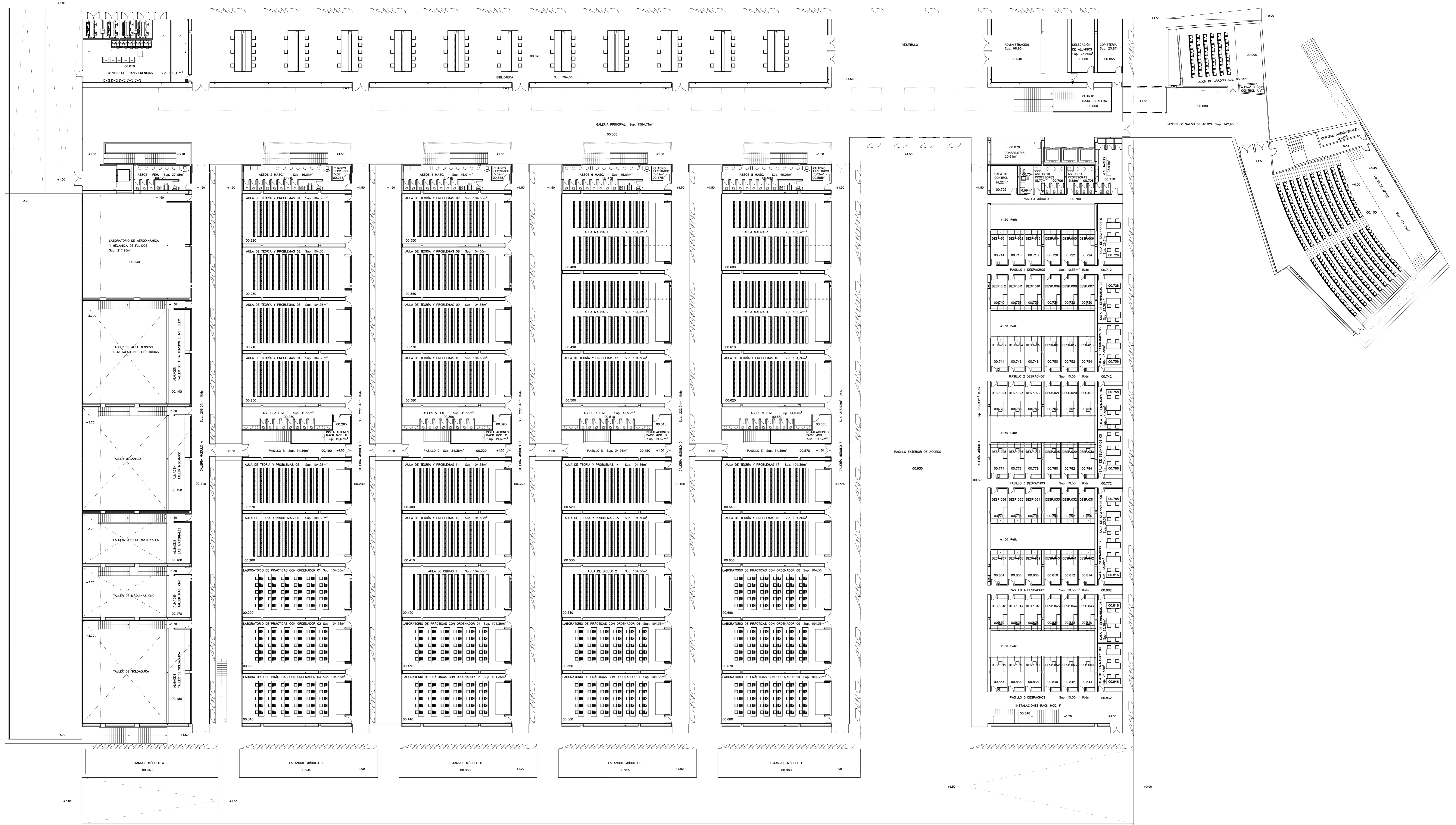

SUPERFICIES
 SUP.CONST.- 11.929,83m²
 SUP.UTIL.- 10.533,73m²
 GALERIAS.- 997,64m²

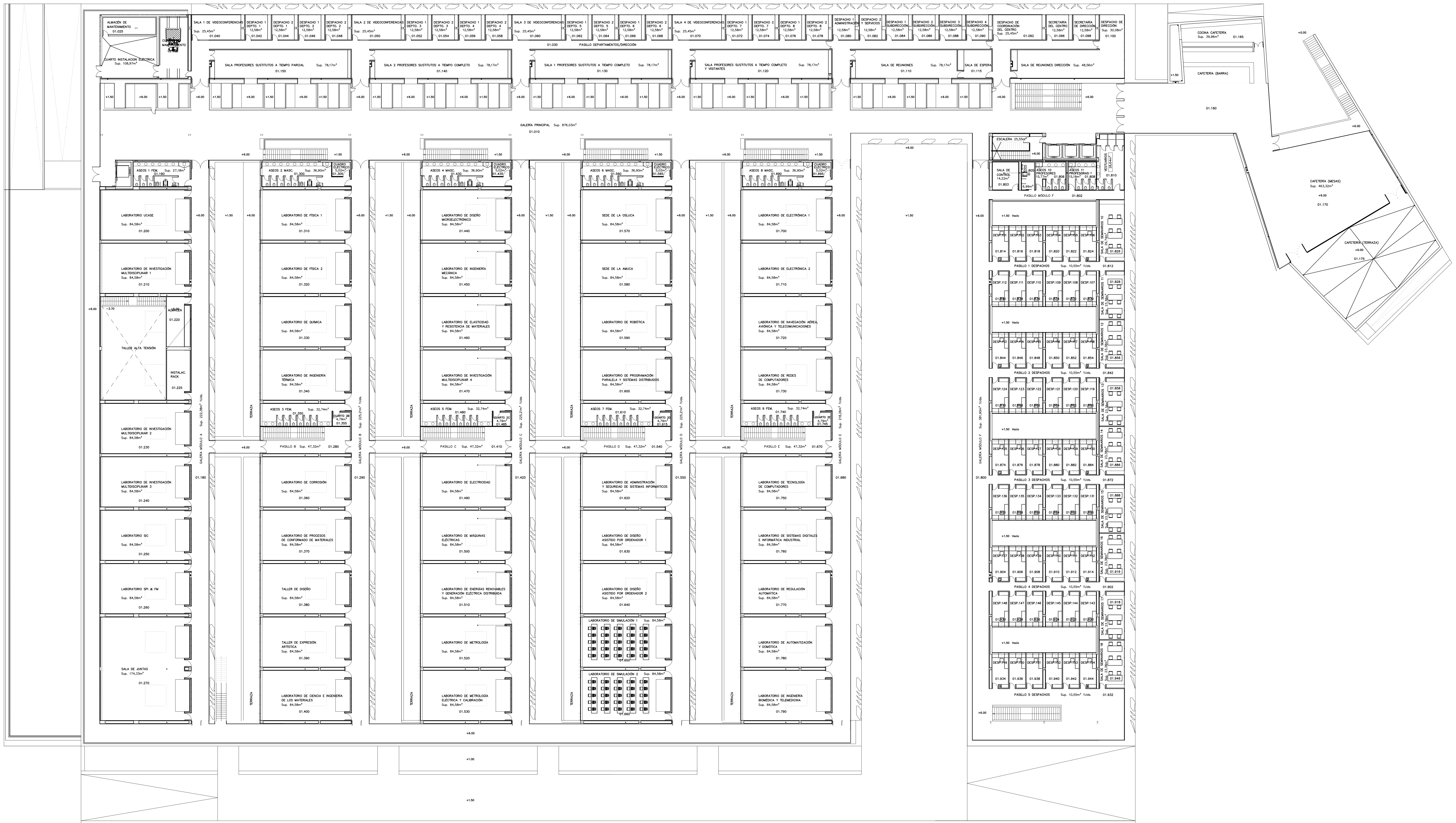

SUPERFICIES	PLANTA ALTA
SUP.CONST.-	10.705,07m ²
SUP.UTIL.-	9.048,04m ²
GALERIAS.-	1.209,14m ²

